

**\* DCM ( DISCOVERY CENTER )**



- Rear Ports  
1. A/V Output  
2. DC In  
3. DVI In  
4. VGA In  
5. S-Video In  
6. Audio In  
7. Audio Out

- 1. A/V OUTPUT : PORT TO CONNECT TO ADDITIONAL DISPLAY SUCH AS TV OR OTHER MONITORS.**
- 2. DC IN : PORT FOR 12VDC POWER ADAPTER.**
- 3. DVI IN : PORT TO CONNECT TO SOURCES THAT HAVE DVI OUTPUT.**
- 4. VGA IN : PORT TO CONNECT TO PC COMPUTERS.**
- 5. S-VIDEO IN : PORT TO CONNECT TO SOURCES THAT HAVE S-VIDEO OUTPUT SUCH AS : DVD PLAYERS,VCD PLAYERS etc.**

**6. AUDIO IN : PORT TO CONNECT TO AUDIO OUTPUT FROM DVD PLAYERS,VCD PLAYERS etc.**

**7. AUDIO OUT : PORT TO CONNECT TO EXTERNAL SPEAKERS.**

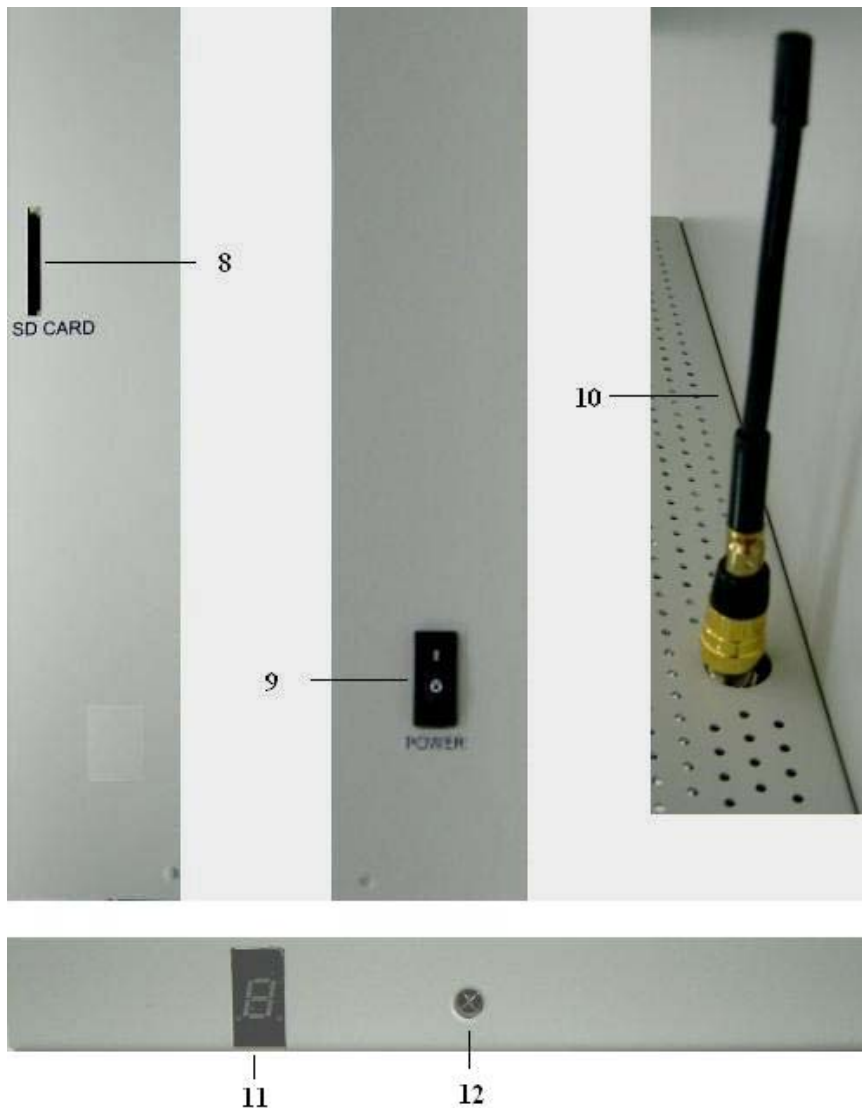

**8. SD CARD : SLOT FOR SD CARD TO SAVE IMAGES.**

**9. POWER : SWITCH TO ACTIVATE WIRELESS IMAGES CAPTURE AND SD CARD IMAGES STORAGE SYSTEM.**

**10. ANTENNA FOR BUILT IN WIRELESS RECEIVER.**

**11. LED DISPLAY FOR CURRENT WIRELESS CHANNEL.**

**12. INFRARED RECEIVER FOR REMOTE CONTROL.**

**PS : POWER BETWEEN LCD DISPLAY AND WIRELESS IMAGES CAPTURE SYSTEM ARE SEPARATE THEREFORE ALTHOUGH WIRELESS IMAGES CAPTURE IS SHUT DOWN,LCD DISPLAY STILL CAN USE FOR OTHER PURPOSE.**

**\* REMOTE CONTROL AND APPLICATIONS**

**FREEZE** For capturing images.

**DELETE** For deleting unwanted images when recalling or previewing images.

**□/田** For select full page image or quad images.

**RECALL** For recalling the captured images. After pressing this button, the screen will appear previous captured images start from **page 1**.

**NEG** Negatoscope function

Monitor  
↕  
X-ray Panoramic Film Viewer

**B/W** Turn the images between **color** and **black/white** mode.

**IS** Image Stabilizer function.

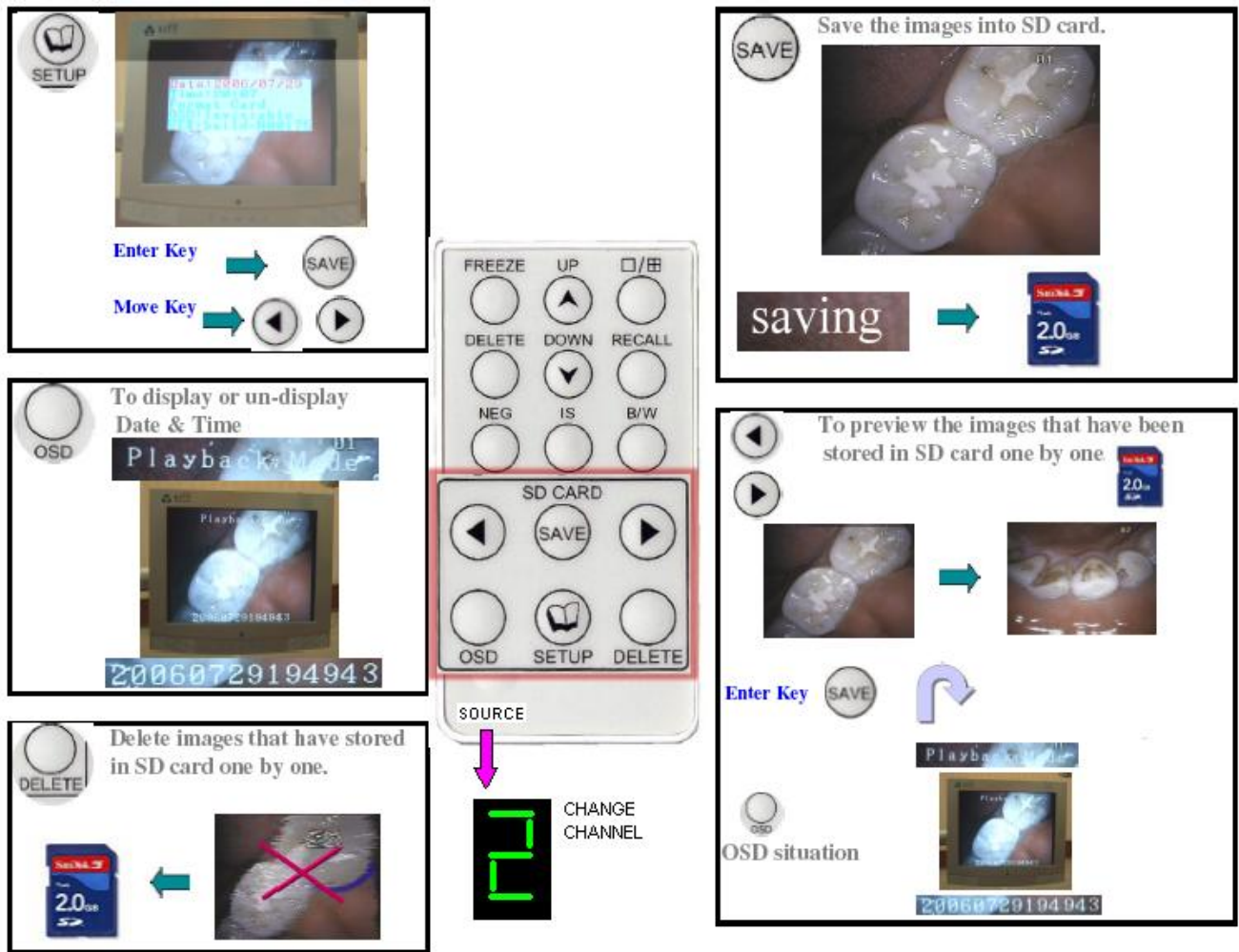

**NOTE :**

- **THE LARGER THE CAPACITY STORED INSIDE SD CARD, IT WILL TAKE MORE TIME TO START FOR DISCOVERY CENTER.**
- **2 GB IS MAXIMUM CAPACITY RECOMENDED FOR SD CARD.**
- **PLEASE INSERT SD CARD BEFORE STARTING DISCOVERY CENTER.**
- **DISCOVERY CENTER ONLY CAN READ THE IMAGES THAT CREATED BY IT SELF . IT CANNOT READ IMAGES THAT CREATED BY OTHER SOURCE.**